

SAE Tank Mount Suction Strainers

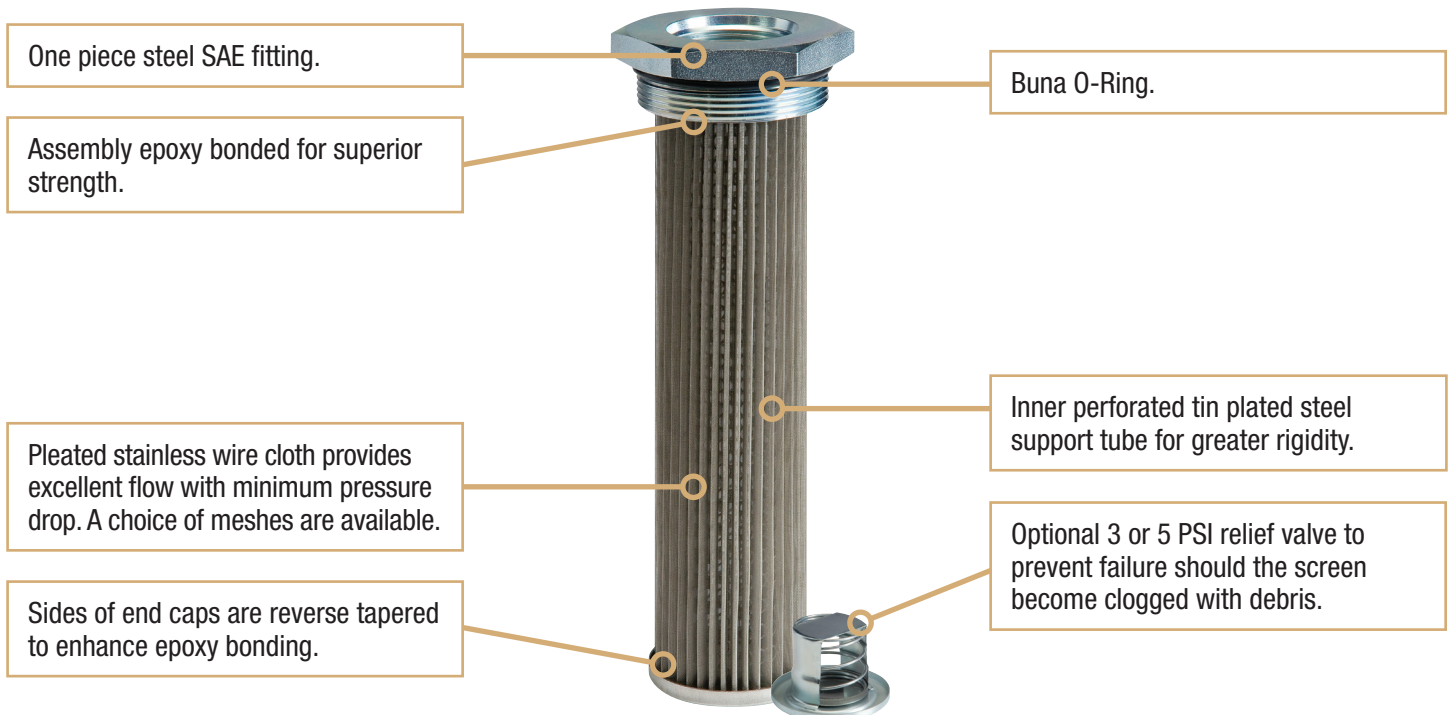

Benefits

- Zinc plated steel bushing
- SAE O-ring threads
- Epoxy bonded stainless steel pleated screen
- Flow rates to 25 gpm
- Perforated steel support tube

Features

SAE Tank Mount Suction Strainers are used in hydraulic fluids, coolants, lubricants, and many process fluids.

A tank-mounted strainer is installed through a tank top and may be removed for servicing without draining the tank.

Options

- 3 or 5 psi bypass
- Custom sizes, screens and adapters

Distributors Wanted!

SAE Tank Mount Suction Strainers

Assembly	Model #	"A" NPT	"B" NPT	"C" (+/- .125)	"D" Ref.	"E" (+/- .064)	Screen Area (sq/in)
0-7320-1	SAE-5-1608	SAE 16	SAE 8	5.417	1.125	1.13	36
0-7320-2	SAE-10-2012	SAE 20	SAE 12	7.976	1.000	1.36	65
0-7320-3	SAE-15-2416	SAE 24	SAE 16	8.018	1.000	1.660	89
0-7320-5	SAE-25-3220	SAE 32	SAE 20	8.668	1.000	2.120	127
0-7320-6	SAE-25-3224	SAE 32	SAE 24	8.659	1.000	2.120	127

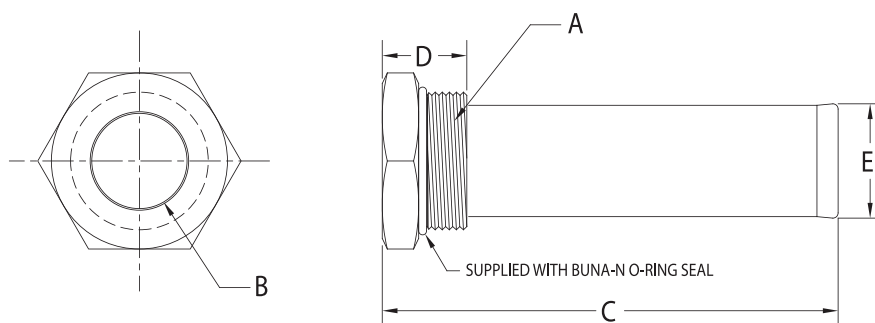

Filter Mesh: 100 Mesh is Standard

Mesh Suffix	Mesh Opening	Open Area
200	.0029" (74 Microns)	33.6%
100	.0055" (140 Microns)	30.2%
60	.0102" (260 Microns)	37.3%

How to Order

Assembly Suffix	Mesh Valves	Optional Relief (RV3 or RV5)
0-7320-1	- 100 -	RV3